

**LRP-W**  
**Paper Handle making Machine (Water-based glue type)**  
**纸手挽机(水胶型)**

**简介:**

本机专为纸袋拎手而研制的新一代手挽机。该机是将纸绳夹在两层牛皮纸中间，经过涂胶、压合、再自动分切成单个手挽。是手提纸袋机生产线的理想配套产品。

**Introduction:**

machine was developed specifically for the new generation of paper Handle Machine. This machine is sandwiched between two layers of kraft paper rope middle, after gluing, lamination, and then automatically cut into a single handle. Paper bag machine is the ideal complementary product lines.

**特点 :**

1. 水基胶成本低，低温不易脱落。
2. 操作方便，速度快

**Features:**

1. Water-based adhesive has low cost and is not easy to fall off at low temperature.
2. easy to operate, fast.

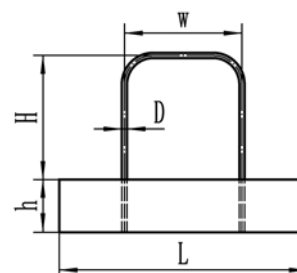
**技术参数 Technical Parameter:**

机型	Type	LRP-W				
纸绳间距 (W)	Handle Spacing (W)	45 mm	63.5 mm	79 mm	<b>95 mm</b>	110 mm
纸片长度 (L)	Paper Board Length (L)	95 mm	127 mm	158 mm	<b>190 mm</b>	222 mm
纸片宽度 (h)	Paper Board Width (h)	30-40 mm				
纸绳直径 (D)	Rope Diameter (D)	3-5 mm				
纸绳高度 (H)	Rope Height (H)	100 mm				
最大速度	Max.Speed	200 pcs/min				
纸张克重	Paper Thickness	80-120 gsm				
纸卷宽度	Paper Roll Width	60-80 mm				
最大纸卷直径	Max.Roll diameter	1000 mm				
纸卷内径	Reel inner diameter	76 mm				
总功率	Total Power	4.5 Kw				
机器重量	Weight of Machine	1500 kg				
外形尺寸	Overall Dimension(LxWxH)	4700x1300x1500 mm				